

Details shown below are graphical representations only. For accurately scaled and dimensioned details, please visit [www.CrystaliteInc.com](http://www.CrystaliteInc.com).

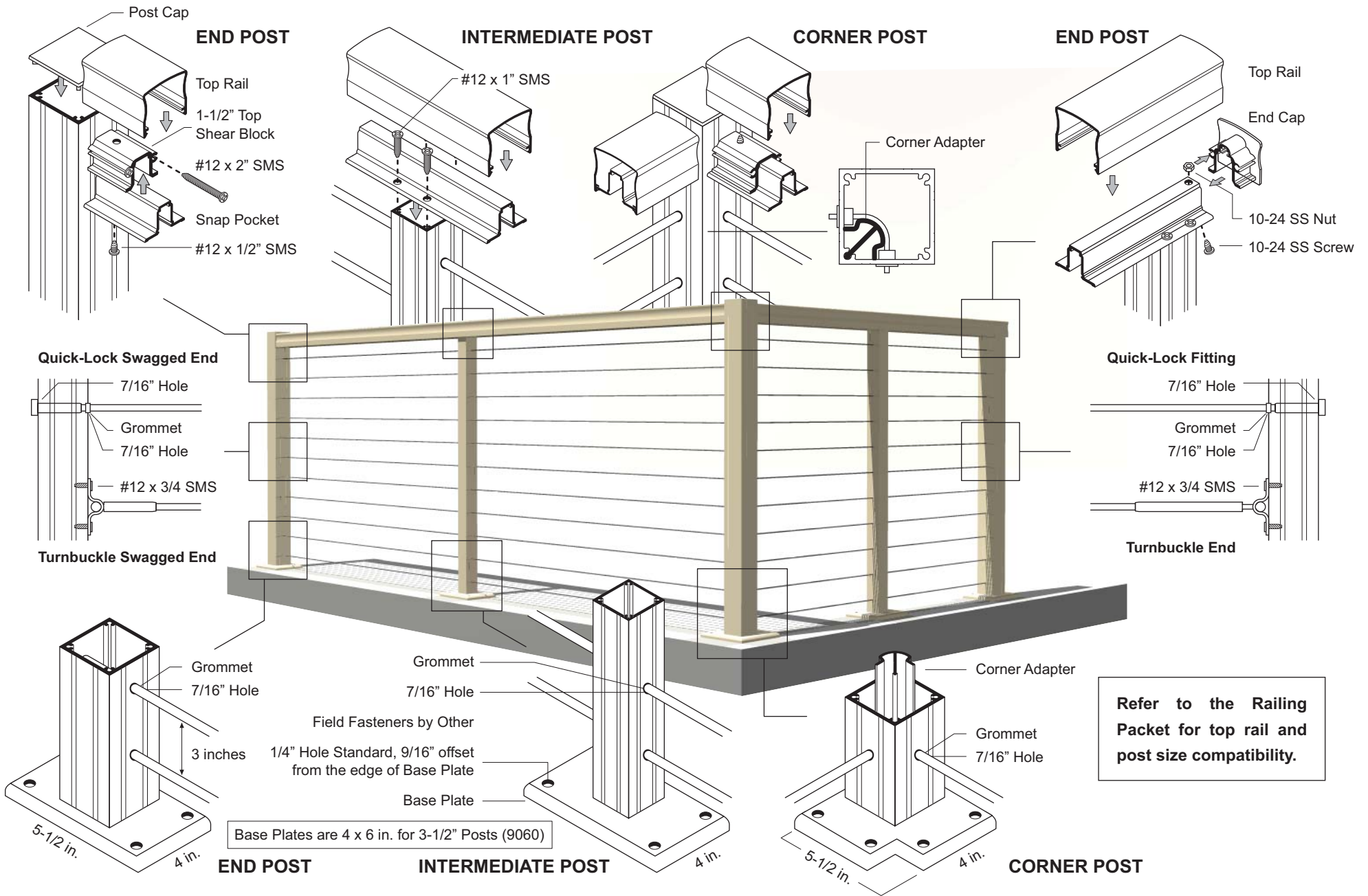

**Refer to the Railing Packet for top rail and post size compatibility.**



**Stainless Steel Cable**

Aluminum Railing System

DECK MOUNT

Crystalite railings are structurally designed and stamped by an independent structural engineer. Crystalite will select the appropriate post size and spacing to meet code requirements for Exposures B, C, and D with wind speeds up to 120 mph.

Details shown below are graphical representations only. For accurately scaled and dimensioned details, please visit [www.CrystaliteInc.com](http://www.CrystaliteInc.com).

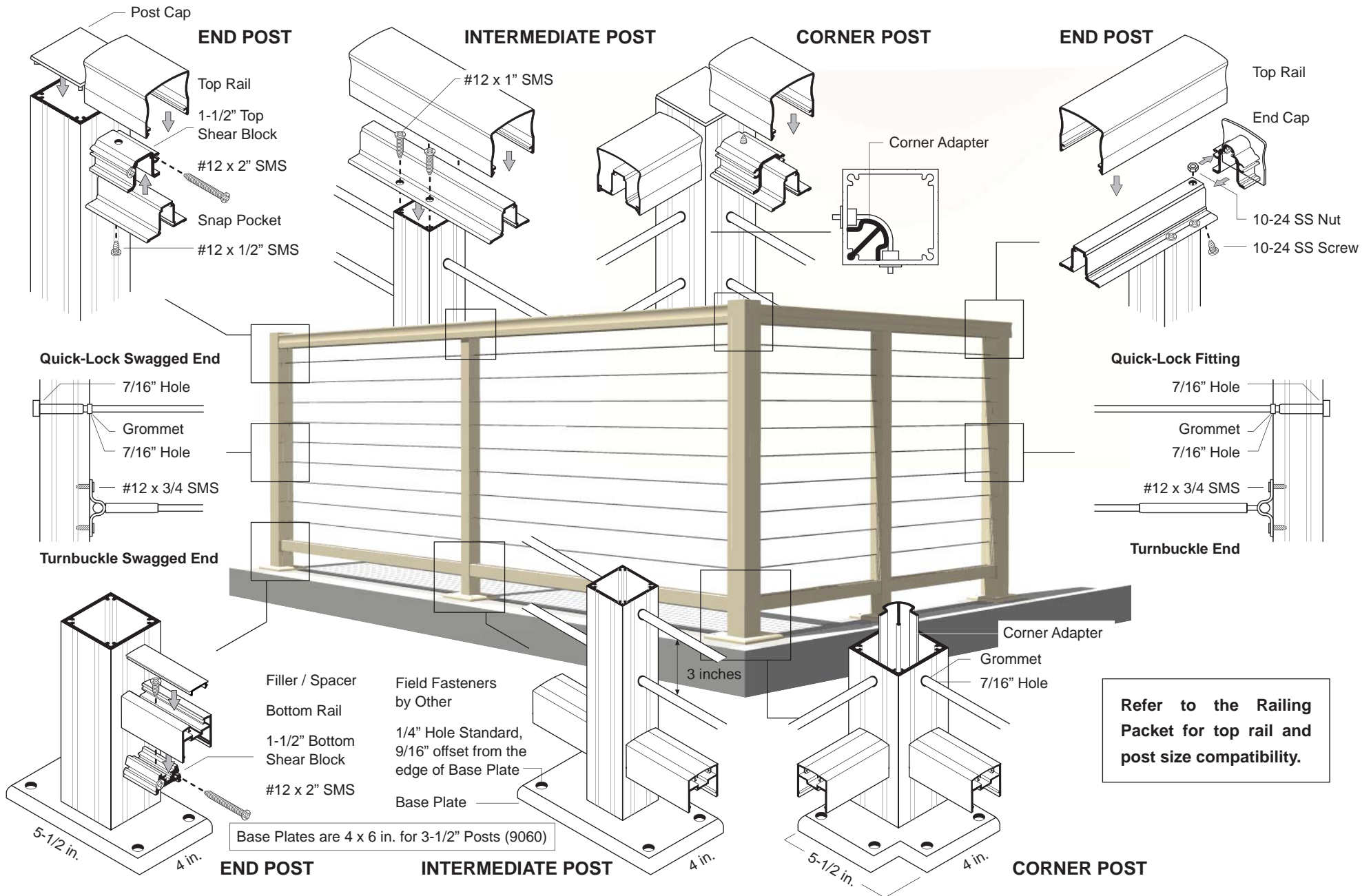

### Stainless Steel Cable

Aluminum Railing System

DECK MOUNT w/ BOTTOM RAIL

Crystalite railings are structurally designed and stamped by an independent structural engineer. Crystalite will select the appropriate post size and spacing to meet code requirements for Exposures B, C, and D with wind speeds up to 120 mph.

Details shown below are graphical representations only. For accurately scaled and dimensioned details, please visit [www.CrystaliteInc.com](http://www.CrystaliteInc.com).

Refer to the Railing Packet for top rail and post size compatibility.

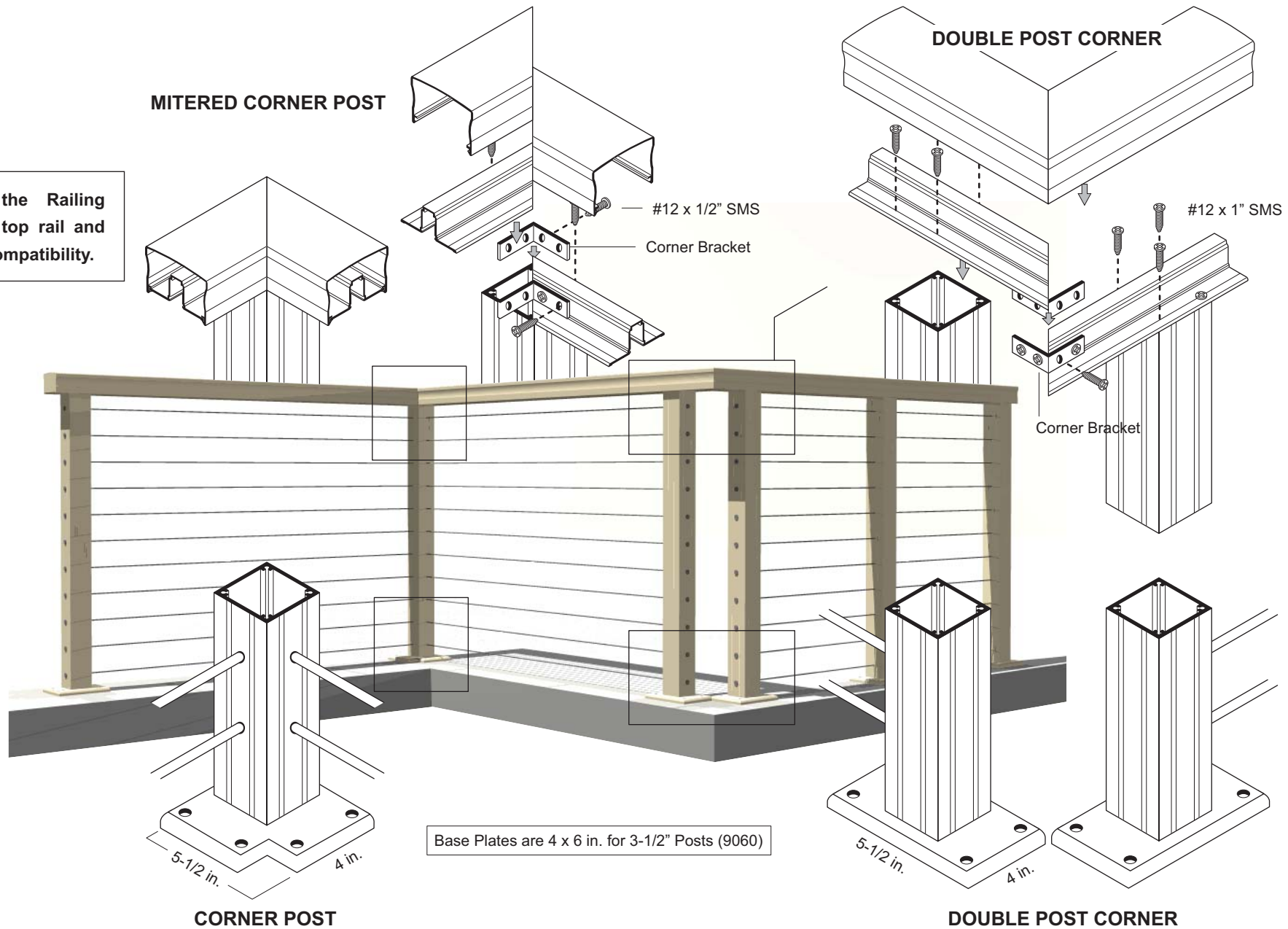

MITERED CORNER POST

DOUBLE POST CORNER

CORNER POST

DOUBLE POST CORNER

Base Plates are 4 x 6 in. for 3-1/2" Posts (9060)



**Stainless Steel Cable**  
Aluminum Railing System  
DM - ALT. INSTALL DETAILS

CrystaLite railings are structurally designed and stamped by an independent structural engineer. CrystaLite will select the appropriate post size and spacing to meet code requirements for Exposures B, C, and D with wind speeds up to 120 mph.

Details shown below are graphical representations only. For accurately scaled and dimensioned details, please visit [www.CrystaliteInc.com](http://www.CrystaliteInc.com).

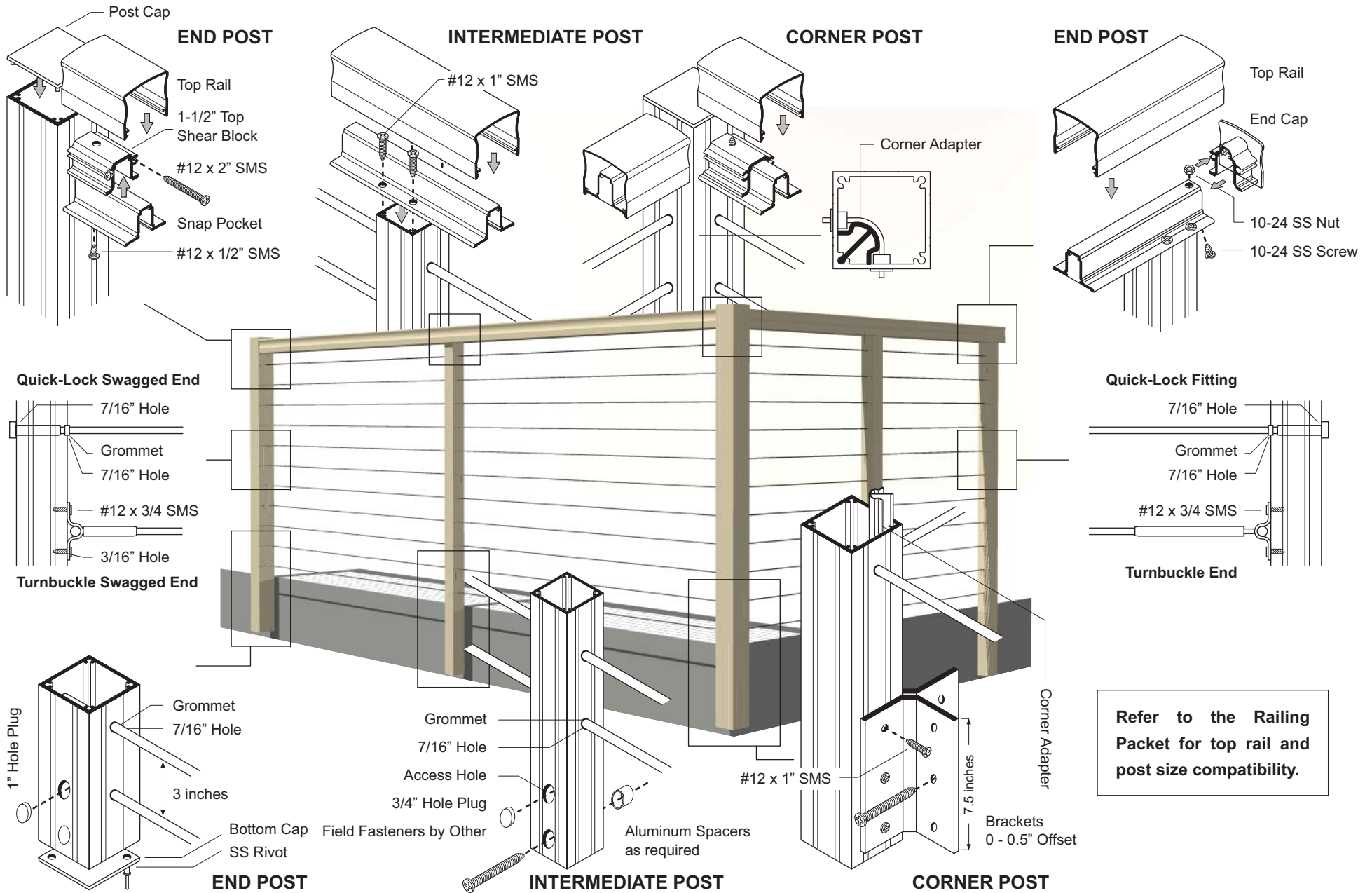

### Stainless Steel Cable

Aluminum Railing System

SIDE MOUNT

Crystalite railings are structurally designed and stamped by an independent structural engineer. Crystalite will select the appropriate post size and spacing to meet code requirements for Exposures B, C, and D with wind speeds up to 120 mph.

Details shown below are graphical representations only. For accurately scaled and dimensioned details, please visit [www.CrystaliteInc.com](http://www.CrystaliteInc.com).

Refer to the Railing Packet for top rail and post size compatibility.

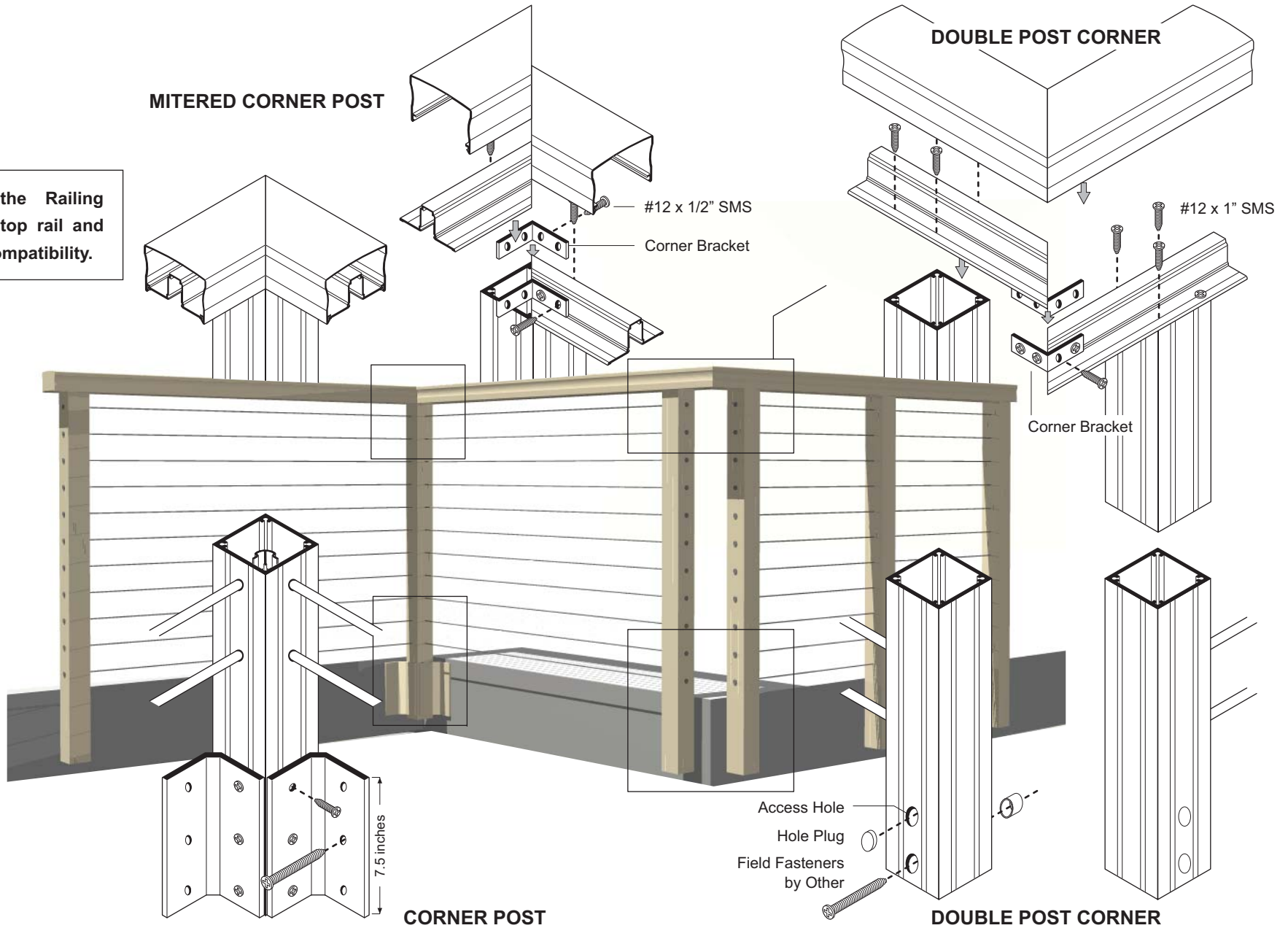

### Stainless Steel Cable

Aluminum Railing System

SM - ALT. INSTALL DETAILS

CrystaLite railings are structurally designed and stamped by an independent structural engineer. CrystaLite will select the appropriate post size and spacing to meet code requirements for Exposures B, C, and D with wind speeds up to 120 mph.

Details shown below are graphical representations only. For accurately scaled and dimensioned details, please visit [www.CrystaliteInc.com](http://www.CrystaliteInc.com).

### GRAB RAIL 90° CORNER

*pre-fabricated corners  
grab rail cut to final  
length at jobsite*

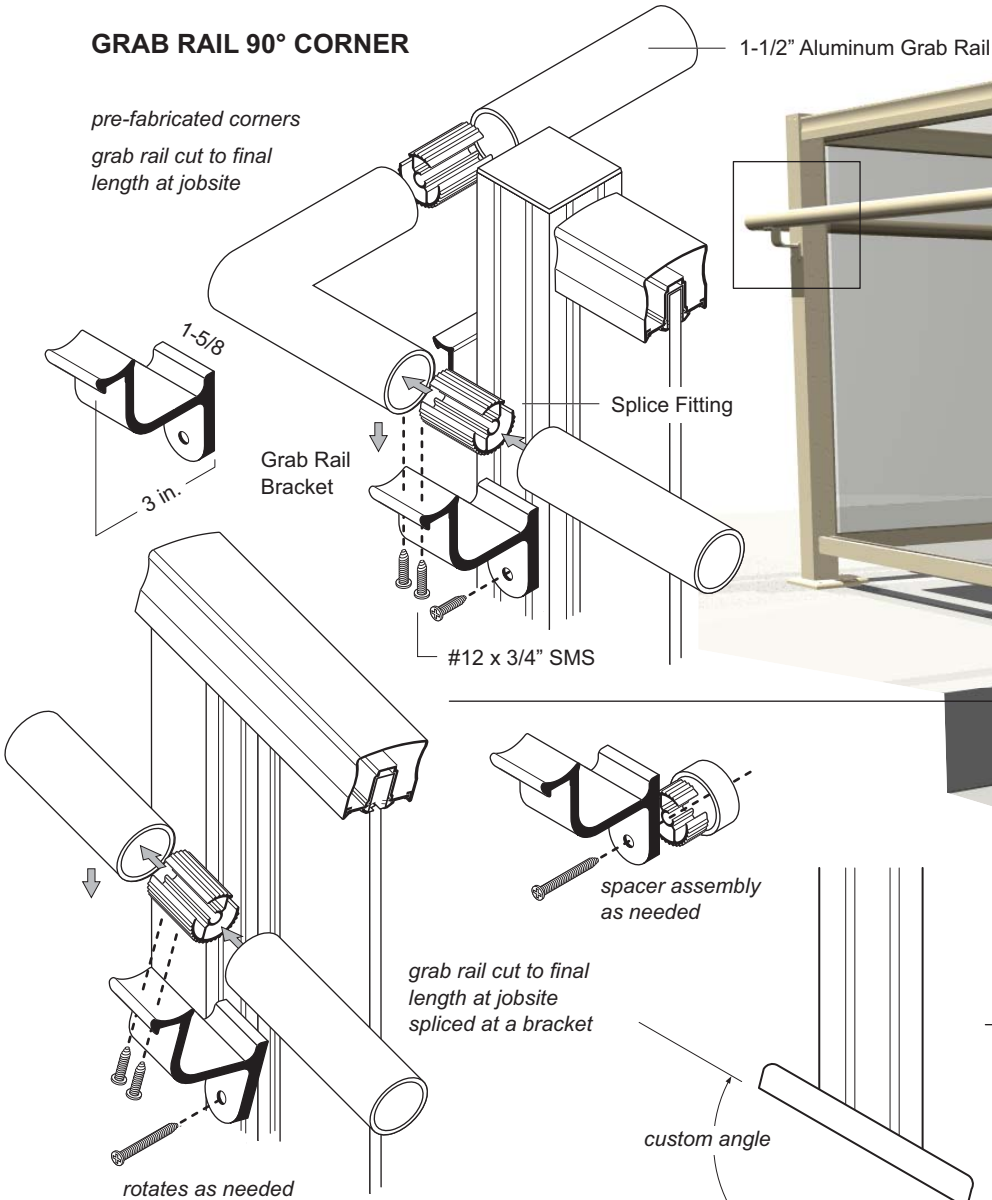

### GRAB RAIL DOWN A SLOPE

### STAIR JACK BASE PLATES

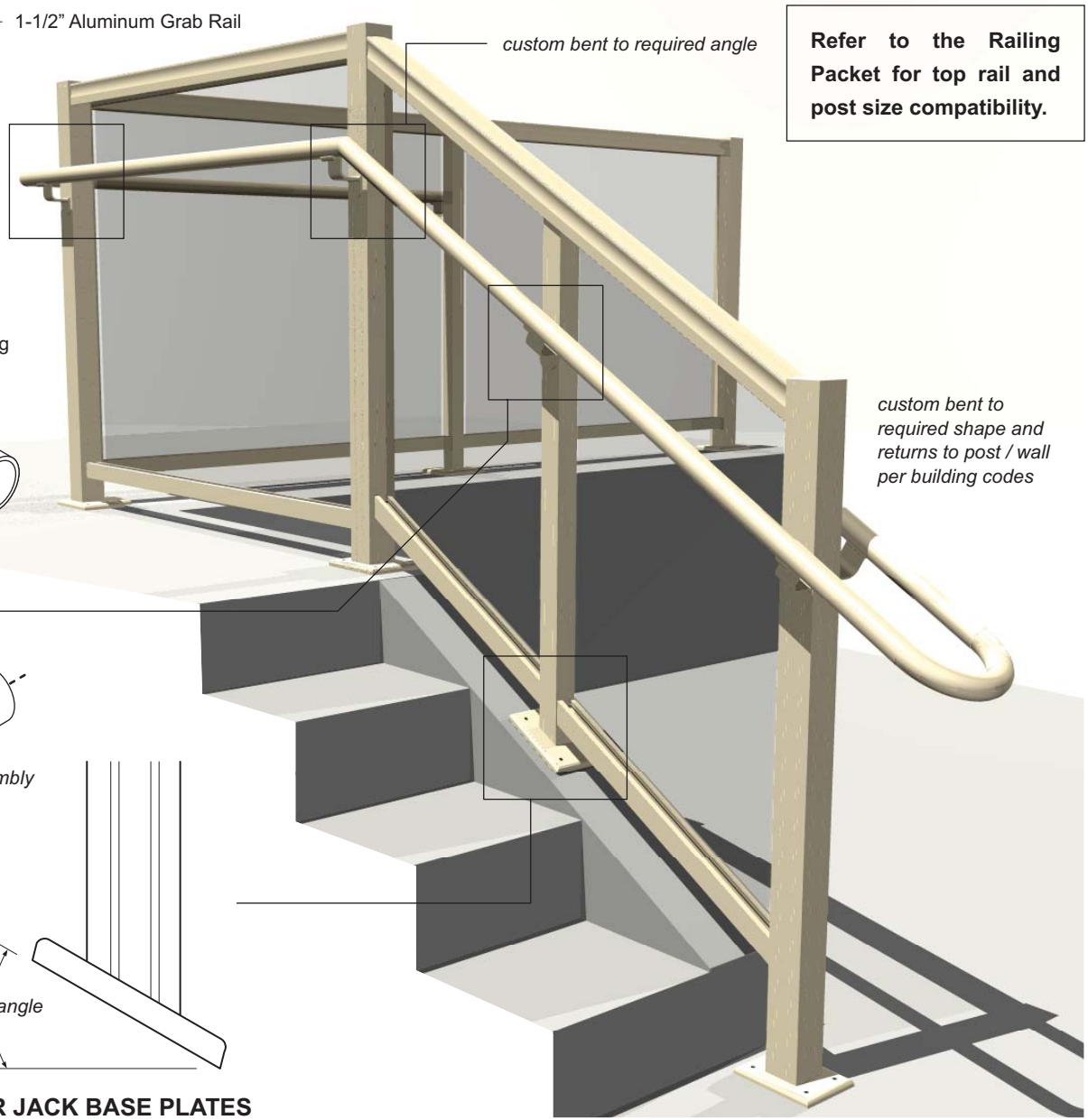

Refer to the Railing Packet for top rail and post size compatibility.



**9020 Grab Rail**  
Aluminum Railing System

Crystalite railings are structurally designed and stamped by an independent structural engineer. Crystalite will select the appropriate post size and spacing to meet code requirements for Exposures B, C, and D with wind speeds up to 120 mph.