

Details shown below are graphical representations only. For accurately scaled and dimensioned details, please visit www.CrystaliteInc.com.

Refer to the Railing Packet for top rail and post size compatibility.

DOUBLE TOP RAIL ASSEMBLY

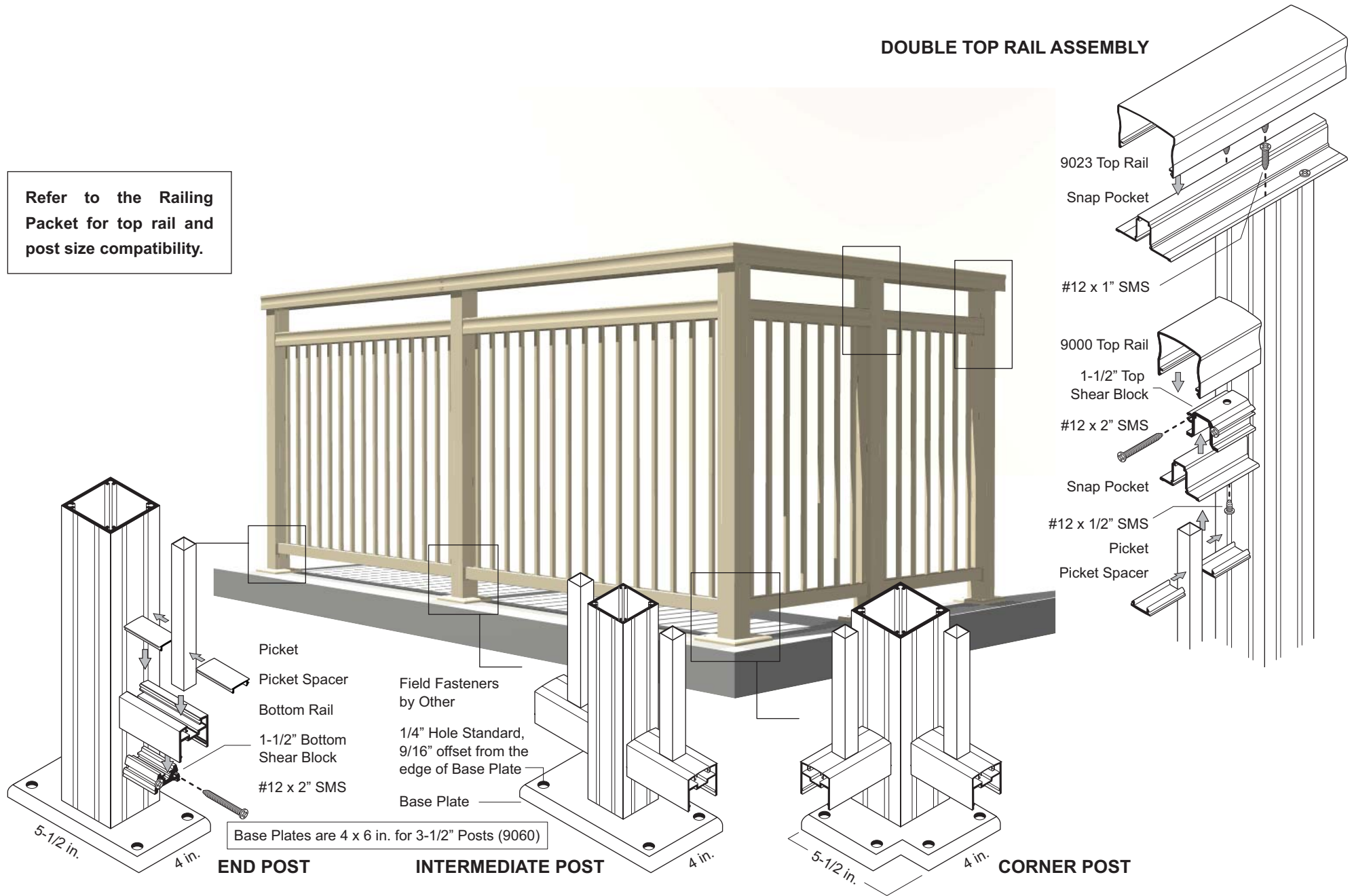

Aluminum Picket
Aluminum Railing System

DOUBLE TOP RAIL

Crystalite railings are structurally designed and stamped by an independent structural engineer. Crystalite will select the appropriate post size and spacing to meet code requirements for Exposures B, C, and D with wind speeds up to 120 mph.

Details shown below are graphical representations only. For accurately scaled and dimensioned details, please visit www.CrystaliteInc.com.

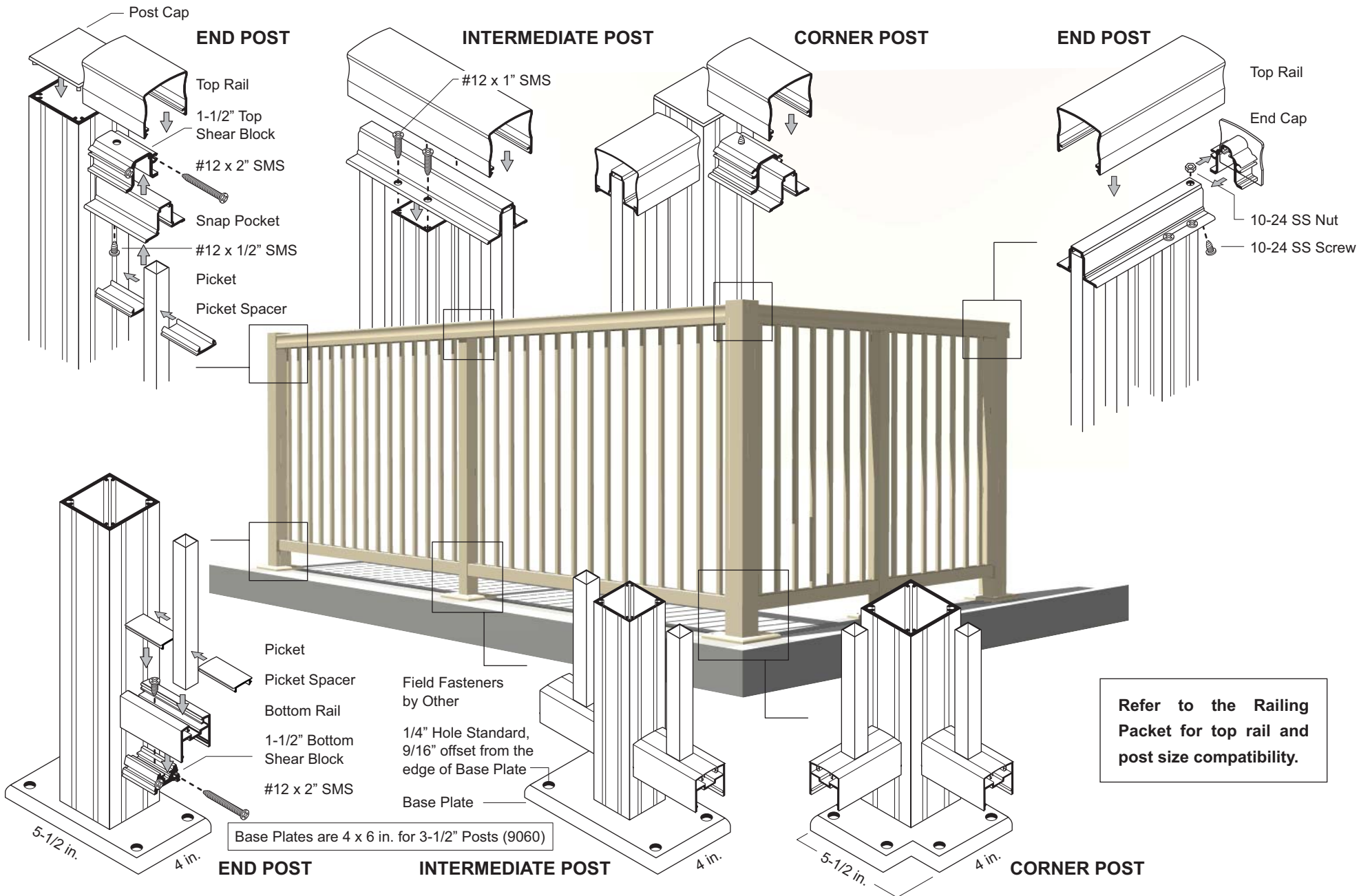

Aluminum Picket

Aluminum Railing System

DECK MOUNT

Crystalite railings are structurally designed and stamped by an independent structural engineer. Crystalite will select the appropriate post size and spacing to meet code requirements for Exposures B, C, and D with wind speeds up to 120 mph.

Details shown below are graphical representations only. For accurately scaled and dimensioned details, please visit www.CrystaliteInc.com.

Refer to Top Rails & Posts handout for top rail and post size compatibility.

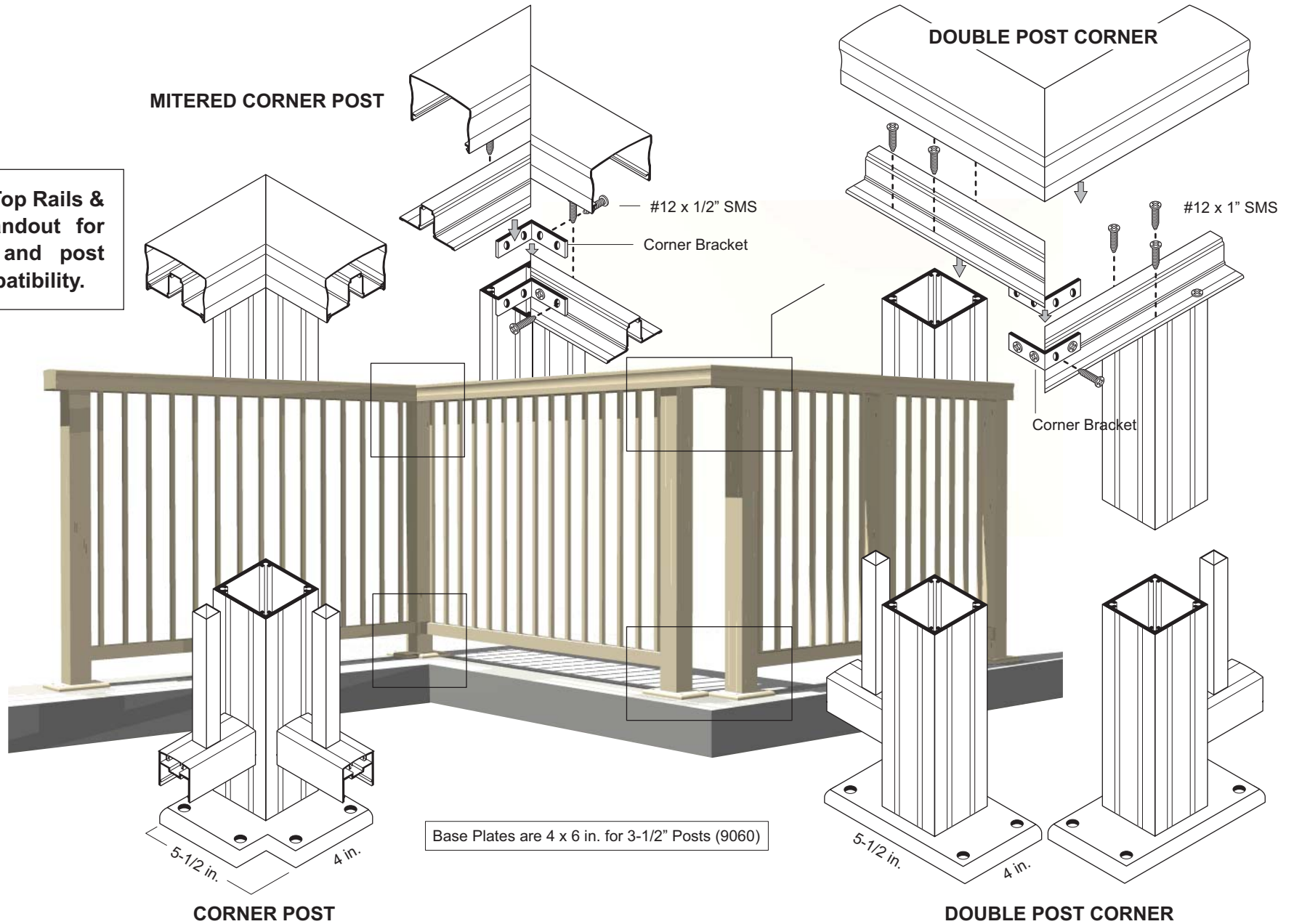

Aluminum Picket
Aluminum Railing System
DM - ALT. INSTALL DETAILS

Crystalite railings are structurally designed and stamped by an independent structural engineer. Crystalite will select the appropriate post size and spacing to meet code requirements for Exposures B, C, and D with wind speeds up to 120 mph.

Details shown below are graphical representations only. For accurately scaled and dimensioned details, please visit www.CrystaliteInc.com.

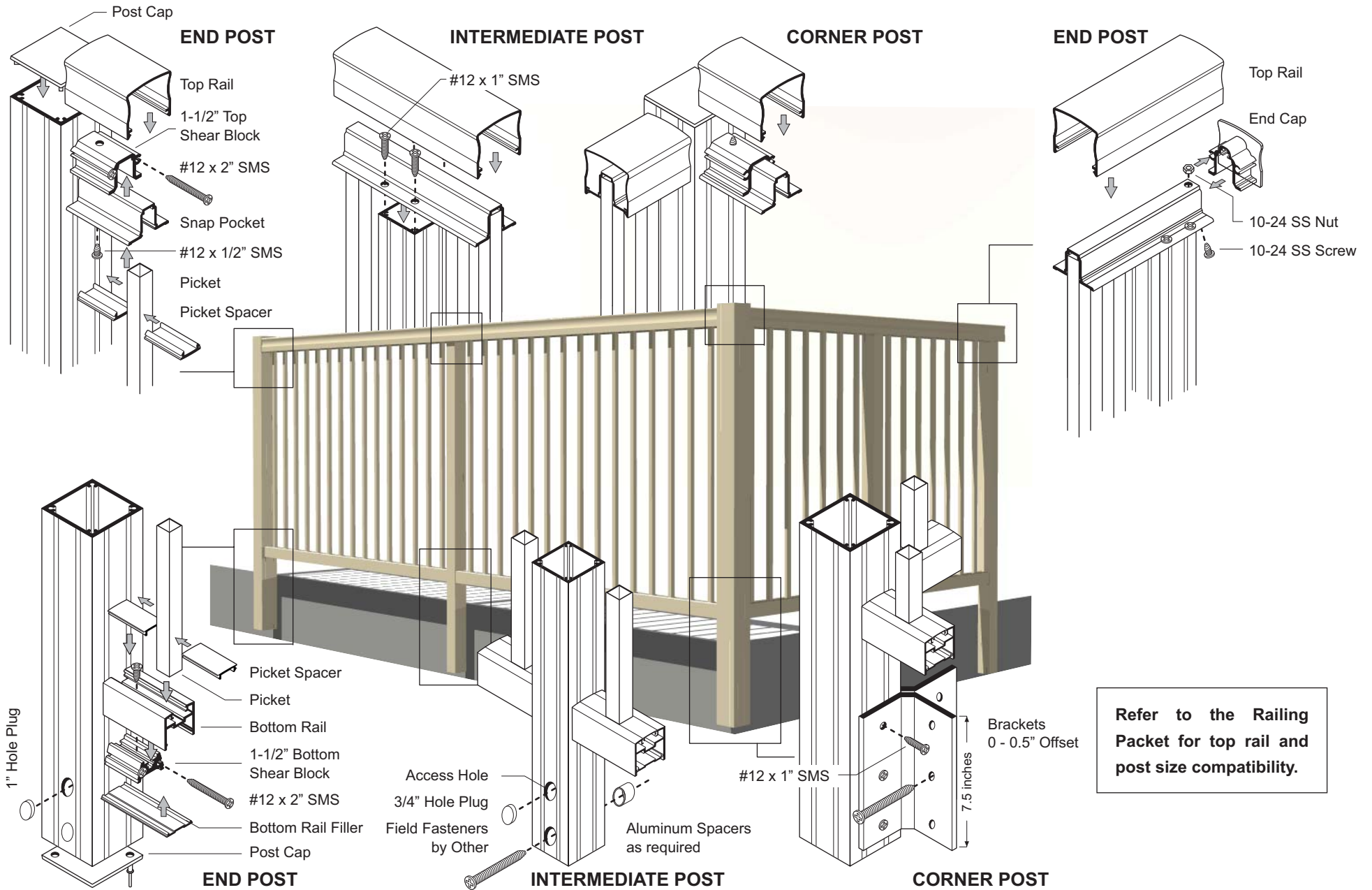

Refer to the Railing Packet for top rail and post size compatibility.



Aluminum Picket
Aluminum Railing System
SIDE MOUNT

Crystalite railings are structurally designed and stamped by an independent structural engineer. Crystalite will select the appropriate post size and spacing to meet code requirements for Exposures B, C, and D with wind speeds up to 120 mph.

Details shown below are graphical representations only. For accurately scaled and dimensioned details, please visit www.CrystaliteInc.com.

Refer to the Railing Packet for top rail and post size compatibility.

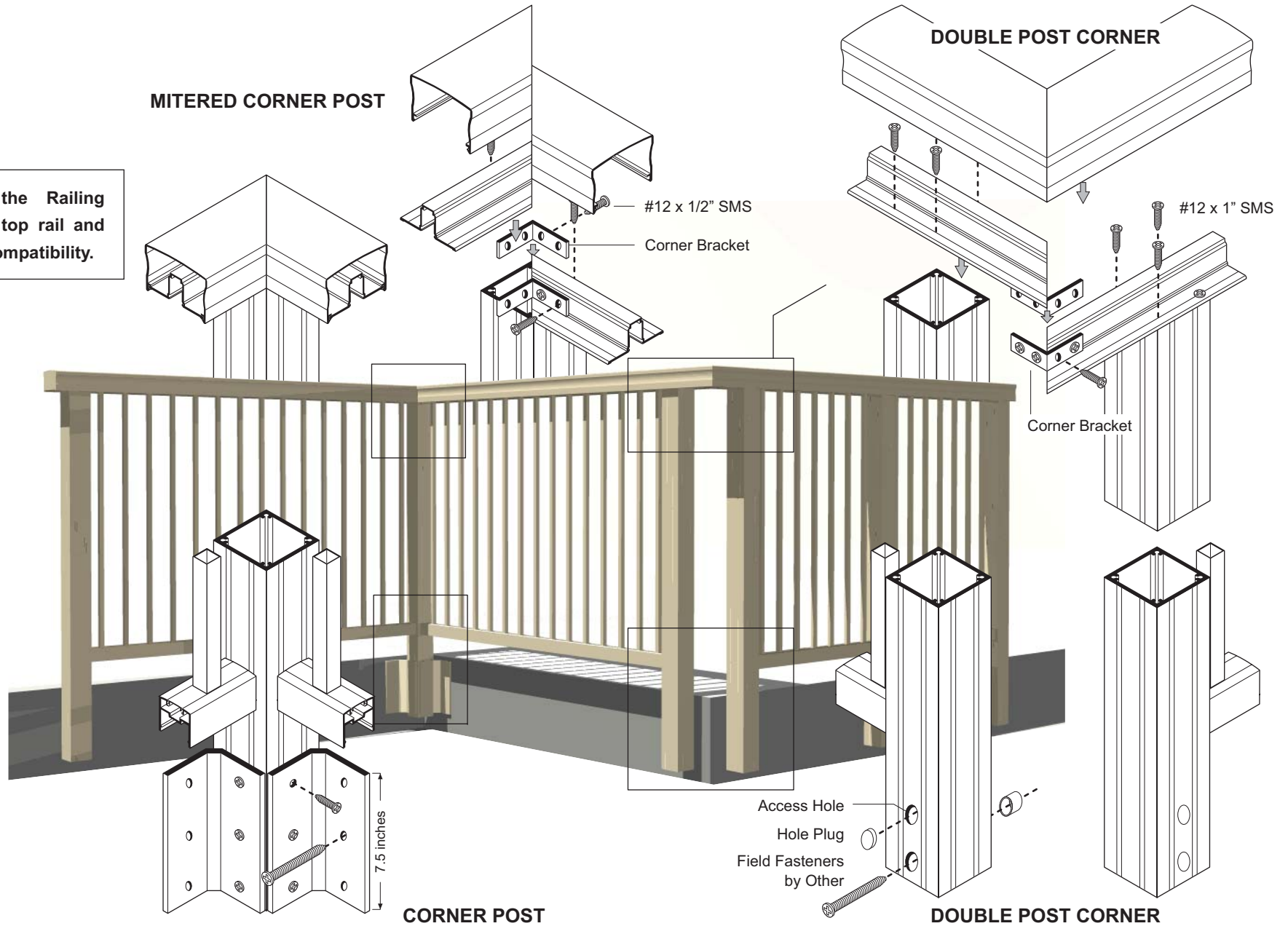

Aluminum Picket
Aluminum Railing System
SM - ALT. INSTALL DETAILS

Crystalite railings are structurally designed and stamped by an independent structural engineer. Crystalite will select the appropriate post size and spacing to meet code requirements for Exposures B, C, and D with wind speeds up to 120 mph.

Details shown below are graphical representations only. For accurately scaled and dimensioned details, please visit www.CrystaLiteInc.com.

GRAB RAIL 90° CORNER

*pre-fabricated corners
grab rail cut to final
length at jobsite*

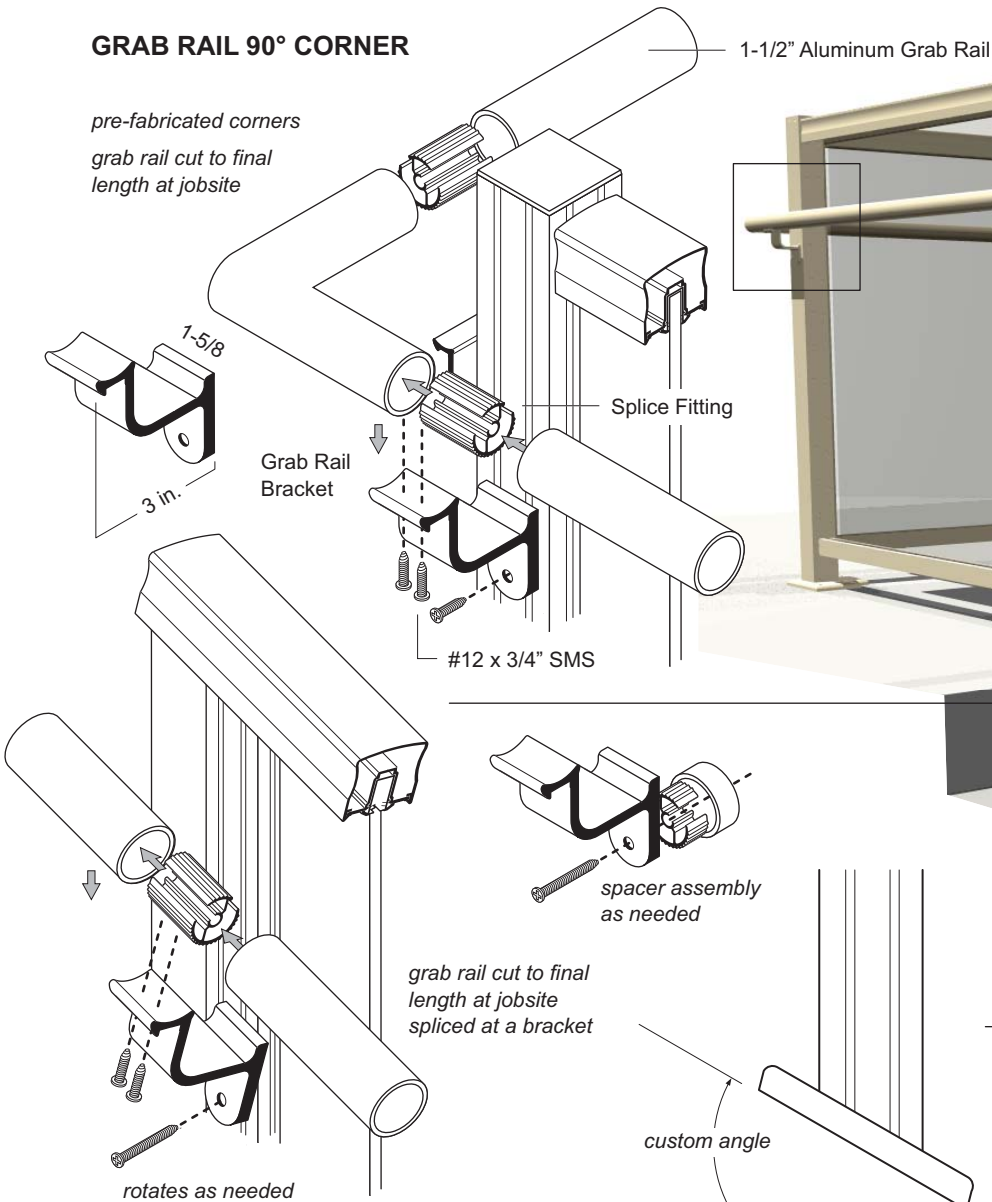

GRAB RAIL DOWN A SLOPE

STAIR JACK BASE PLATES

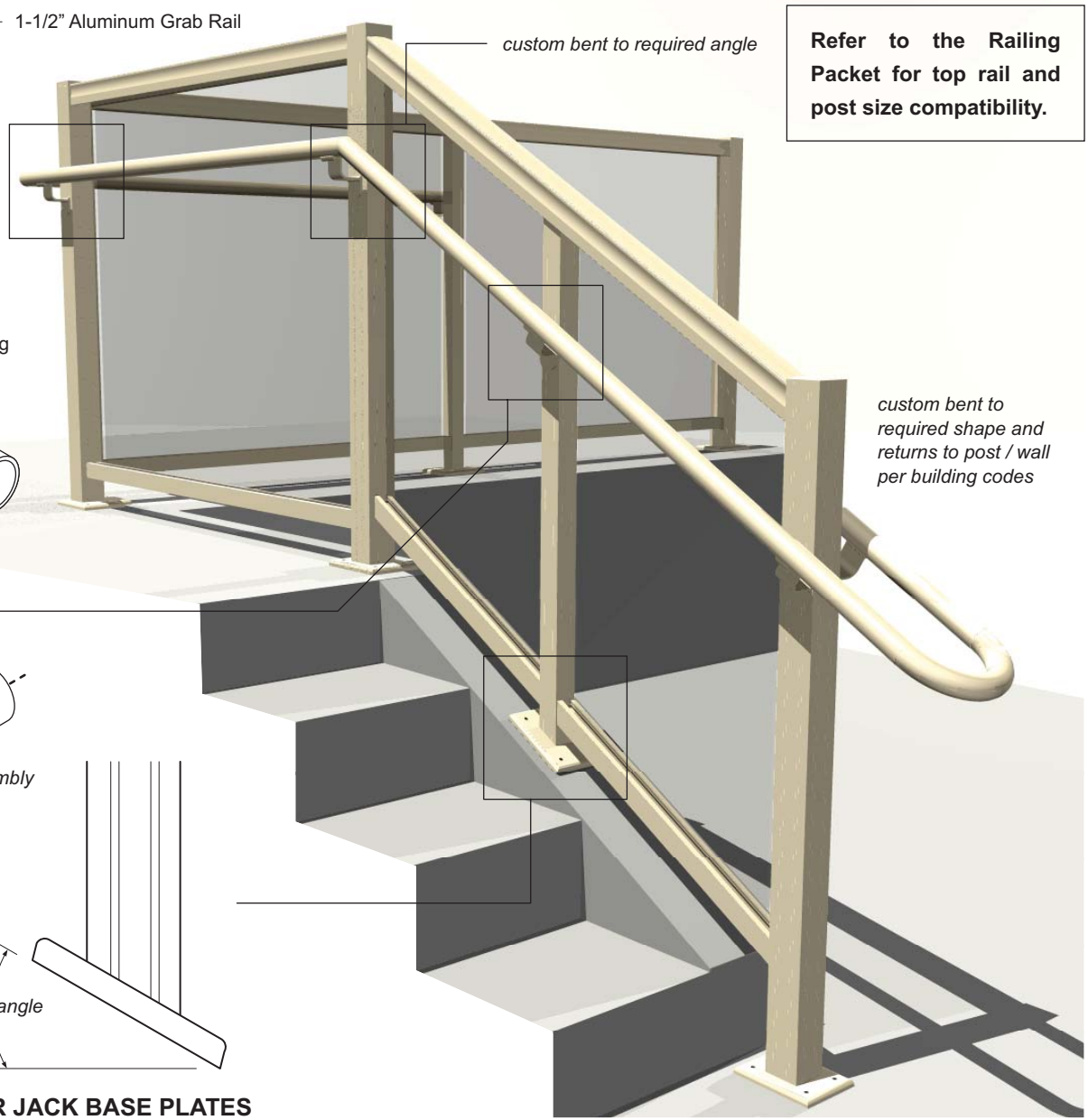

Refer to the Railing Packet for top rail and post size compatibility.



9020 Grab Rail
Aluminum Railing System

CrystaLite railings are structurally designed and stamped by an independent structural engineer. CrystaLite will select the appropriate post size and spacing to meet code requirements for Exposures B, C, and D with wind speeds up to 120 mph.