

## Skylight & Solar Smart Installation

1. Remove the Solar Smart battery cover and plug the battery pack into the operator.
2. Using the manual buttons inside the battery cover, open the skylight a few inches in case needing exterior access later.
3. Place the opened skylight on to the curb.
4. Attached the Mounting Clips to the Solar Panel Mounting Bracket.
5. Snap the Solar Panel to the Skylight's Cap with the Mounting Clips.

The Solar Panel is typically installed on the upper edge of the skylight, but can be installed on a side edge as well. Choose the side which will provide the best solar exposure.

6. Rotate the Solar Panel for optimal Sun exposure, then tighten down. Angling towards the South is typically best, or straight up when not South facing.
7. Secure the Solar Panel Wire with Cable Ties and the Adhesive Tabs.
8. Before fastening the Skylight to the curb, be sure to maintain an equal reveal on all sides, centering the skylight on both directions.
9. Push down on the skylight to compress the curb tape and secure the skylight to the top of the curb using the provided fasteners at the pre-drilled holes of the base frame. Do not over tighten. **Do not install fasteners on the hinge side of the frame.**
10. **Check Solar Charge Rate (mA) to ensure the Solar Panel is connected properly to prevent future dead battery issues.**

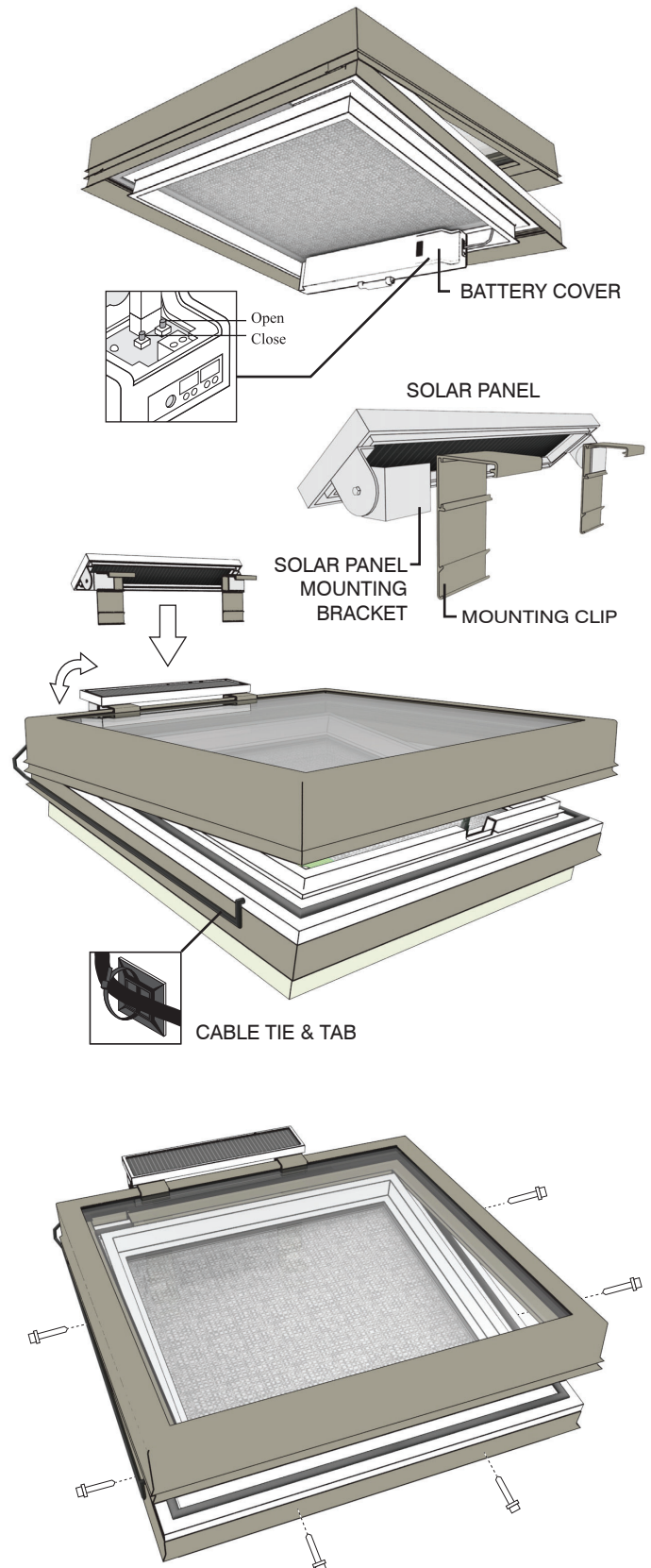

### Minimum Solar Charge (mA) readings in SUMMER MONTHS

Overcast Conditions: 20 mA minimum (30+ mA typical)

Blue Sky Conditions: 60 mA minimum (80+ mA typical)

### Minimum Solar Charge (mA) readings in WINTER MONTHS

Overcast Conditions: 10 mA minimum (20+ mA typical)

Blue Sky Conditions: 30 mA minimum (40+ mA typical)